



RFL4A-CY-16

VERSATRIM ADJUSTABLE CYLINDER

JOB INFORMATION

Type: _____
 Catalog No: _____
 Project Name: _____
 Comments: _____
 Prepared by: _____

FEATURES

USE OF PRODUCT

The Versatrim Adjustable Cylinder Series may be used in hospitality, commercial, retail, and residential interior applications. This product will reduce energy consumption, emits little heat, and reduces cooling loads for added costs savings. Approximately 75% in energy savings compared to incandescent light source.

HOUSING

Rugged aluminum housing.

ARCHITECTURAL CYLINDER FEATURES

- Wattage: 11 Watts
- Lumens: 900 Lumens
- Voltage: 120V standard; 120-277V (with optional 0-10V dimming driver)
- Color Temperature: 2700K, 3000K, 3500K, 4000K
- SDCM: 2 Step binning
- R9 Value: 85
- Color Rendering Index: 93 CRI Typical
- LED Life: 50,000 hours
- LED Type: Cree LED for maximum light output
- Versatility: Interchangeable baffle, reflector and trim ring
- Warranty: 5 Year Limited Warranty

DIMMING

Available in 11 driver selections. Standard Triac/ELV, 120V. (019) 0-10V dimming in 900 lumens, 120-277V. (PEQ0) Lutron Hi-Lume Premier Ecosystem 0.1% w/ soft on, fade to black dimming, 120-277V. (PEQ1) Lutron Hi-Lume Premier Ecosystem 1% w/soft on, fade to black dimming, (LDE1) Lutron Hi-Lume 1% Ecosystem with soft on, fade to black dimming, 120-277V. (LTE) Lutron Hi-Lume 1% 2-wire, 120V. (L3DA) Hi-lume 1% EcoSystem/3-Wire L3D Driver (EEI) eldoLED Eco 1% Dim (0-10V), 120-277V. (EDIO) eldoLED Solo 0.1% Dim(0-10V), 120-277V. (EDID) eldoLED Solo 0.1% Dim(DALI), 120-277V.

MOUNTING

The Versatrim Adjustable Cylinder Series may be cable hung, stem mount, surface mount or wall mounted.

MODULE MECHANICS

The Versatrim Cylinder Series is constructed of a durable heat sink, baffle or reflector, trim ring, diffused lens, and Cree LEDs for optimum performance. Carefully designed heat sink keeps junction temperatures below unsuitable levels by dissipating heat away from the module. Diffused polycarbonate impact-resistant lens allows for even

light output, glare control, and conceals LEDs from view. The Adjustable Cylinder Series provides 0-30° tilt and 360° Rotation.

LABELS / COMPLIANCE

CSA classified
 CSA classified for damp locations

ORDERING INFO

SERIES	DIAMETER	SHAPE	LENGTH	WATT/LUMENS	COLOR TEMP.	DIMMING
RFL	4A - 4" Adjustable	CY - Cylinder	16 - 16" MTO - Made to order	9L - 11W/ 900lm (120V)	35K - 3500K 40K - 4000K	Black ¹ - TRIAC/ELV (120V) - 0-10V (900lm, 120-277V) ID - Standard all-inclusive ELV, Triac, and 0-10V dimming driver (Intelligent Drive) PEQ0 - Lutron Hi-Lume Premier Ecosystem 0.1% w/soft on, fade to black dimming PEQ1 - Lutron Hi-Lume Premier Ecosystem 1% w/soft on, fade to black dimming LDE1 - Lutron Hi-Lume 1% Ecosystem with soft on, fade to black dimming LDE5 - Lutron Hi-Lume 5% Ecosystem LTE - Lutron Hi-Lume 1% 2-wire L3DA - Hi-lume 1% EcoSystem/3-Wire L3D Driver EEI ² - eldoLED Eco 1% Dim (0-10V) EDIO ² - eldoLED Solo 0.1% Dim (0-10V) EDID ² - eldoLED Solo 0.1% Dim (DALI)

CYLINDER FINISH	LENS HOLDER FINISH	BEAM ANGLE	REFLECTOR	TRIM	CONFIGURATION	MOUNTING	OPTION
BL - Black	HW - White	18 - 18°	4ARLW - White	ROUND	DL - Down Light	PH ⁴ - Pendant Hung	019 - 0-10V (900 Lumens)
WH - White	HB - Black	38 ³ - 38°	4ARLB - Black	4TLW - White		SC ⁵ - Single Cable	E - Emergency Back-up
SL - Silver	HS - Silver	60 - 60°	4ARLCH - Chrome	4TLC - Copper		DC - Double Cable	SDT - Step Down Transformer
MTO - Made to order			4ARLH - Haze	4TLB - Black		TC - Triple Cable	H - Honey comb
			4ARLSN - Satin Nickel	4TLH - Haze		SM - Surface Mount	F - Frosted Filter
			4ARLC - Custom	4TLSN - Satin Nickel		WM ⁶ - Wall Mount	
				4TLBZ - Bronze			
				4TLCX - Custom			

Notes
 1. 120V only.
 2. Must specify logarithmic or linear eldoLED driver.
 3. Standard beam angle.
 4. 18" Standard length, Consult factory
 5. 5' Standard cable length
 6. Emergency Not available



RFL4A-CY-16

VERSATRIM ADJUSTABLE CYLINDER

DIMENSIONS

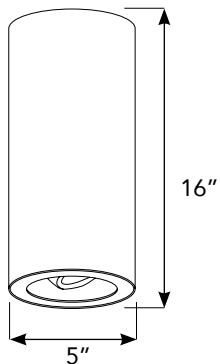

MOUNTING

CABLE HUNG DIMENSION

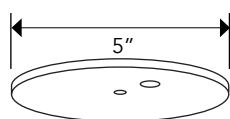

Cable Hung Canopy

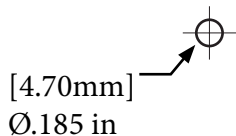

STEM MOUNT DIMENSION

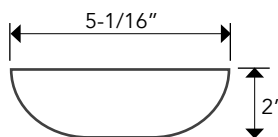

Stem Mount Canopy

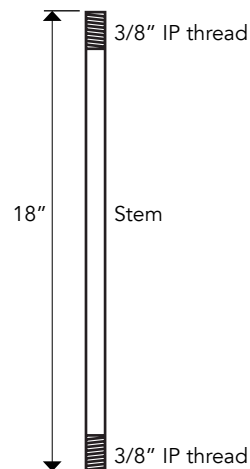

3/64" Galvanized Cable Fuse Cut with Die Cast #1 Stop
Available in 24", 36", 50", 72", 100", 120", & 150" Lengths
7x7 Cable - MAX LOAD 270 lbs